

## duemila SERIES RBY2050 RBY2060 RBY2080

HEAVY OIL

**PNEUMATIC ATOMIZATION WITH ELECTRONIC OPERATION**  
with viscosity up to 4000 cSt at 50°C (530°E at 50°C)

Just like the corresponding DUEMILA series, these oil burners - up to 4.000 cSt at 50°C (530°E at 50°C) - including emulsified oils, were developed to use compressed air or, when required, steam as a means of atomization in order to achieve better combustion results compared to the one gained using the traditional atomizing systems.

These burners are provided with a low pressure nozzle which allows consumption levels to be kept low and which also limits the general wear of the whole atomization system.

All burners are progressive and are completed with an electrical control cabinet and with a pump oil to be installed by the final user. Furthermore, the nozzle performs an automatic cleaning process at the end of each cycle.

The standard version of burners is set up to atomize compressed air only, when steam is requested for the atomization, the burner will be modified through a specific kit.

Air, or steam, must be present at the burner at pressure from 6 to 10 bar.

Burner are ignited through a pilot which can operate either with natural gas or LPG.



Oil pump set (pump, motor, oil tank and filter) in a separate support, (not assembled on the burner)  
**OPTION**

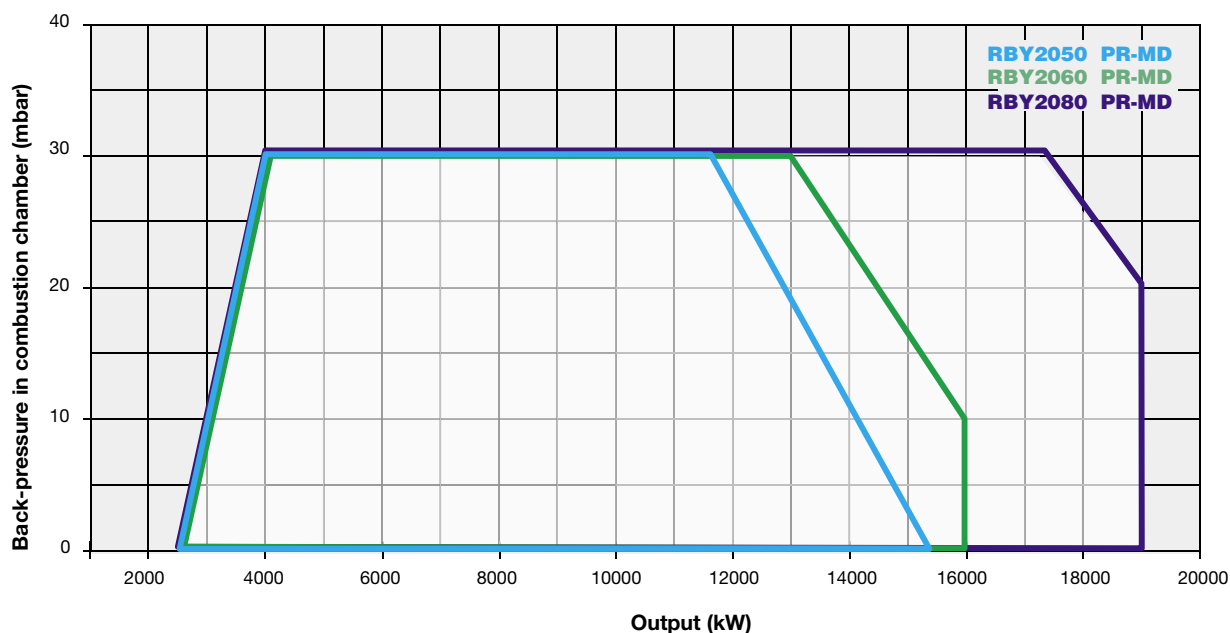

# RBY2050 RBY2060 RBY2080 **duemila** SERIES

**PNEUMATIC ATOMIZATION WITH ELECTRONIC OPERATION**  
with viscosity up to 4000 cSt at 50°C (530°E at 50°C)

## TECHNICAL DETAILS

Type	Model	Output kW		Auxiliary electrical power supply	Motor electrical power supply	Fan motor kW	Pump motor kW	Resistor kW	Noise level dBA
		min.	max.						
<b>RBY2050</b>	H-.xx.S.xx.A.xx	2.500	15.200	230 V 1N AC 50 Hz	400 V 3 AC 50 Hz	37	1,1	24 + 24	92,5
<b>RBY2060</b>	H-.xx.S.xx.A.xx	2.500	16.000	230 V 1N AC 50 Hz	400 V 3 AC 50 Hz	45	1,1	24 + 24	91,7
<b>RBY2080</b>	H-.xx.S.xx.A.xx	2.500	19.000	230 V 1N AC 50 Hz	400 V 3 AC 50 Hz	55	1,1	24 + 24	91,7

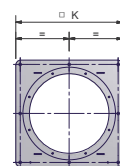
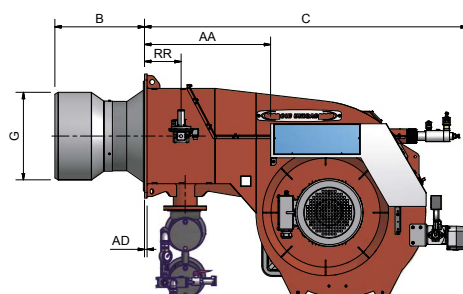
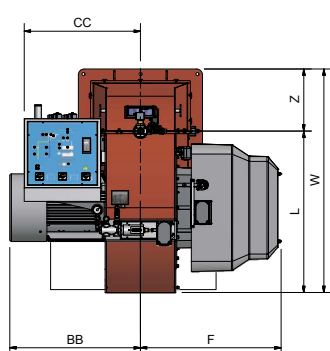

Burner flange

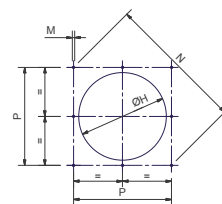

Suggested boiler drilling

The preheaters are included in the scope of supply, assembled in the burner.  
Low pressure pump set (pump, motor and filter) is included, but supplied loose (not on board).  
On request the preheaters and low pressure pump set (pump, motor and filter) can be assembled in a separate support (not on board).

Boiler drilling drill must be confirmed according the firing head.

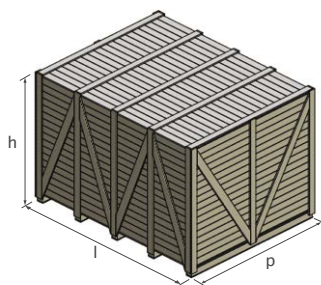

Type	Packaging dimensions (mm)			
	l	p	h	kg
<b>RBY2050</b>	2.396	1.886	1.969	1.370
<b>RBY2060</b>	2.396	1.886	1.969	1.450
<b>RBY2080</b>	2.396	1.886	1.969	1.550

Approximate values

Type	Model	Overall dimensions (mm)																
		AA	AD	B	BB	C	CC	F	G	H	K	L	M	N	P	RR	W	Z
<b>RBY2050</b>	H-.xx.S.xx.A.xx	741	15	*	768	1898	735	827	*	*	730	949	M16	948	670	215	1314	365
<b>RBY2060</b>	H-.xx.S.xx.A.xx	741	15	*	807	1890	735	846	*	*	850	949	M16	1117	790	215	1374	425
<b>RBY2080</b>	H-.xx.S.xx.A.xx	741	15	*	885	1890	735	846	*	*	850	949	M16	1117	790	215	1374	425

\* The B, G, H dimensions must be confirmed from our technical DPT.

Approximate values

# **duemila** SERIES **RB2050 RB2060 RB2080**

HEAVY OIL

**PNEUMATIC ATOMIZATION WITH ELECTRONIC OPERATION**  
with viscosity up to 4000 cSt at 50°C (530°E at 50°C)

Monoblock burners 2000 series are supplied complete with a steel supporting frame; burner installation and manutention are greatly simplified.

The frame is equipped with wheels to easily move the burner, and its height is adjustable to match any type of boiler or furnace.

## **SUPPORTING FRAME FOR BURNERS 2050 SERIES**

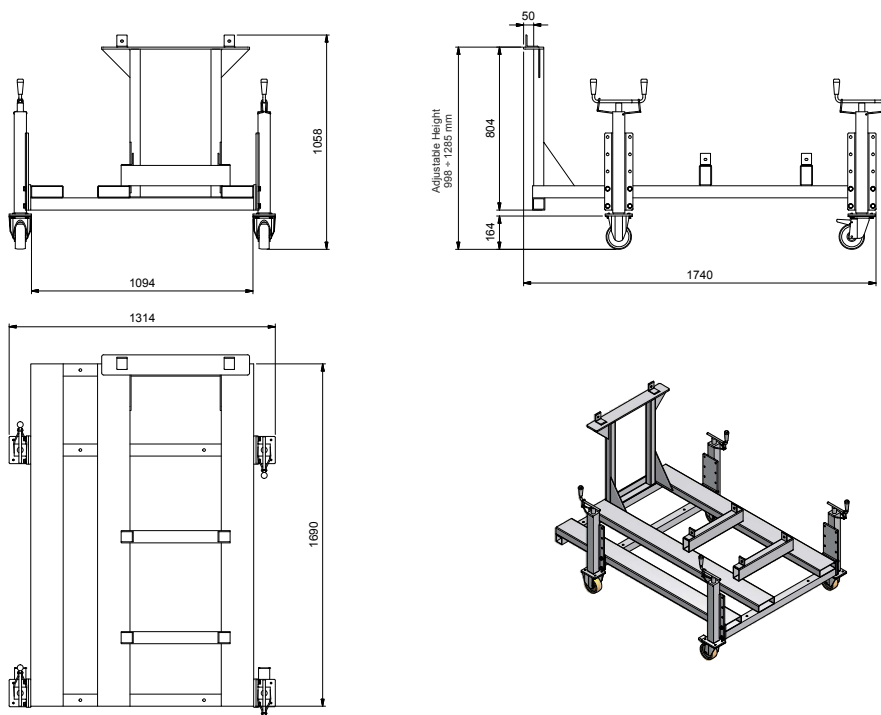

## **SUPPORTING FRAME FOR BURNERS 2060/2080 SERIES**

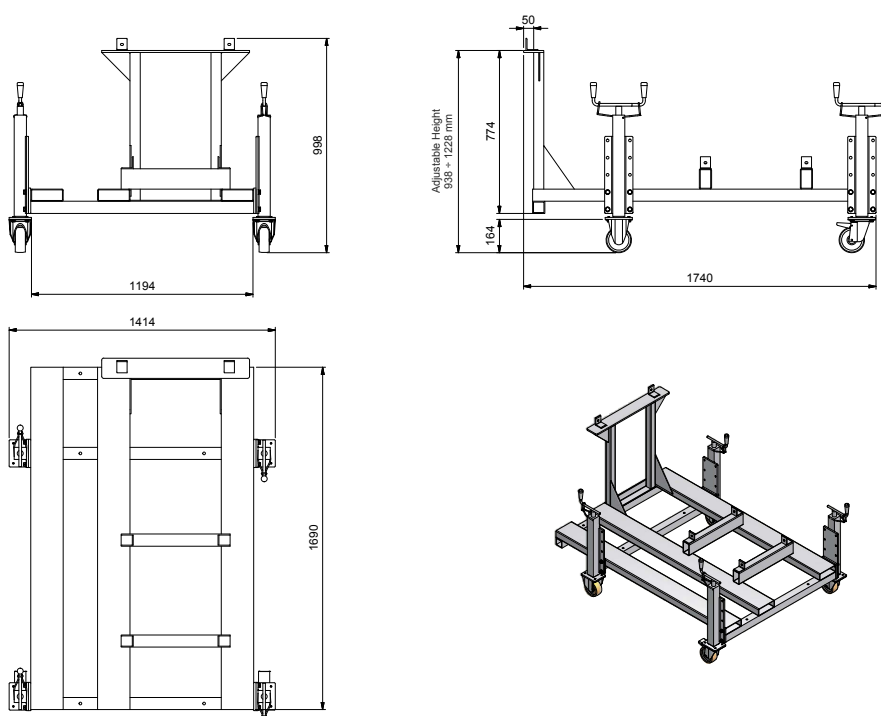

**ELECTRONIC OPERATION**

		<b>RBY2050</b>		<b>RBY2060</b>		<b>RBY2080</b>	
Model	Operation	Code	Price €	Code	Price €	Code	Price €
HEAVY OIL 4000 cSt at 50°C (530°E at 50°C)							
<b>H-PR.S.xx.A.EA</b>	PR (*)	03218045A		-		-	

(\*) Progressive PR control, for modulating version MD add € (see price list)

In the full modulating version MD in order for the supply to be completed, the burner must be equipped with the respective modulating probe (see accessory table, page 282).

**In compliance with:**

- Low Tension Directive 2014/35/UE - Electromagnetic Compatibility Directive 2014/30/UE - Machinery Directive 2006/42/CE

**ELECTRONIC OPERATION**

		<b>RBY2050</b>		<b>RBY2060</b>		<b>RBY2080</b>	
Model	Operation	Code	Price €	Code	Price €	Code	Price €
HEAVY OIL 4000 cSt at 50°C (530°E at 50°C)							
<b>H-MD.S.xx.A.ES</b>	MD (**)	03218045S		03218055S		03218065S	

(\*\*) The burners are already MD version.

In order for the supply to be completed, the burner must be equipped with the respective modulating probe (see accessory table, page 282).

**In compliance with:**

- Low Tension Directive 2014/35/UE - Electromagnetic Compatibility Directive 2014/30/UE - Machinery Directive 2006/42/CE

